

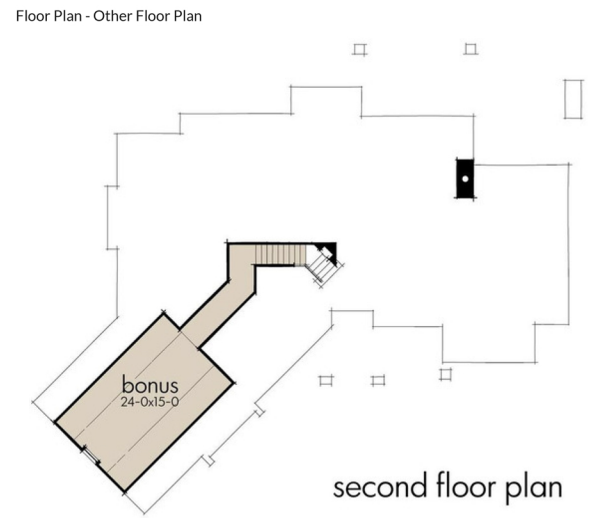

## THE COUNTRY COTTAGE FLOOR PLAN

This house plan has the warmth and comfort of a home you'll want to spend a lot of time in. The stunning exterior takes your breath away with a great balance of wood and stone plus striking eyebrow dormers. Appointed with a wealth of amenities on the inside, the home includes a gourmet kitchen and a formal dining room with wonderful views of the family room. Entertaining in this home is a breeze with its outdoor living areas and barbecue porch warmed by an outdoor fireplace. The master suite has its own trellised porch and a lovely tray ceiling. The split bedroom layout maximizes your privacy. Expand upstairs if more room is needed with 480 square foot ready to be put to most any use.



### SPECIFICATIONS

Main Floor - 2397 sq/ft    Porch - 387 sq/ft  
 Bonus - 480 sq/ft        Garage - 709 sq/ft

### HOUSE FEATURES

- Main Floor Bedrooms
- Split Bedrooms
- Breakfast Nook
- Kitchen Island
- Main Floor Laundry
- Front Entry Garage
- Covered Rear Porch
- Main Floor Master Bedroom
- Walk In Closet
- Walk In Pantry
- Great Room Living Room
- Unfinished Future Space
- Covered Front Porch
- Outdoor Kitchen Grill



405-596-4647 | CULLINSCUSTOMHOMES.COM  
 INFO@CULLINSCUSTOMHOMES.COM